

Building 5: 2351 Oakwood Hills Dr

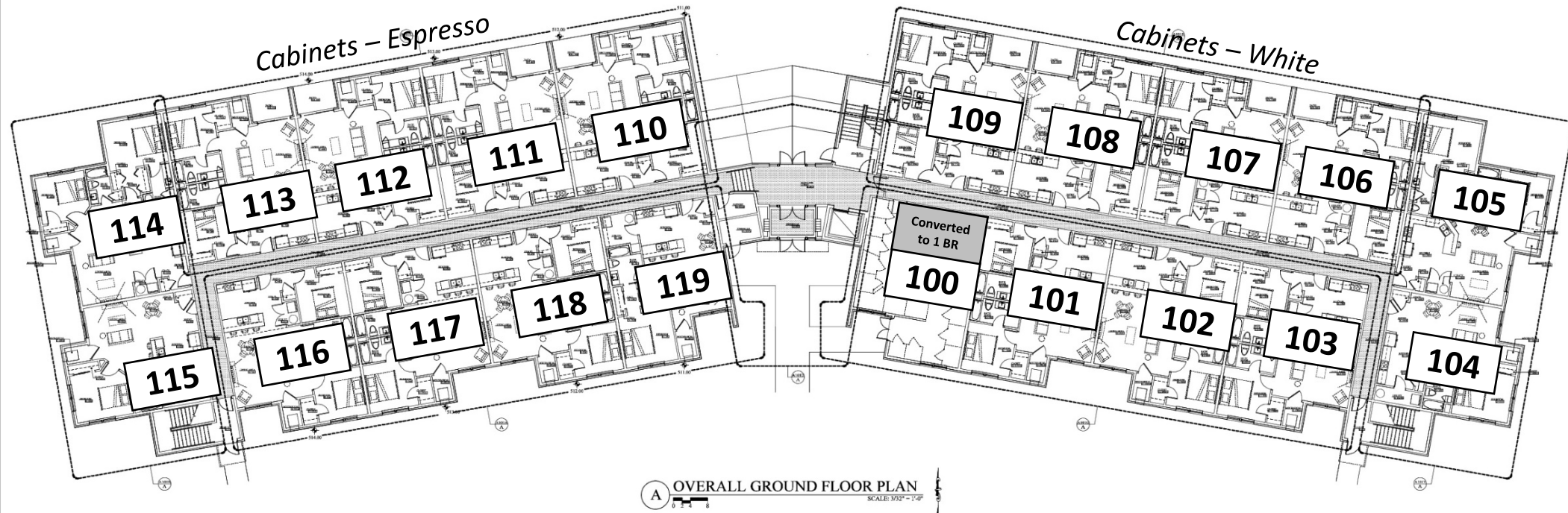

A OVERALL GROUND FLOOR PLAN
SCALE: 3/32" = 1'-0"

REVISIONS		
NO.	REVISION	DATE

BY DESIGN CONSULTANTS, INC.
CAMP HILL, PA. 717.540.1250

PROGRESS PRINT
(Not for Construction)
01 MAR 18

KEY PLAN

PLAN KEY NOTE:
SEE SHEET A-202 FOR "PLAN KEY NOTES" AND OTHER INFORMATION.

OAKWOOD HILLS PLANNED COMMUNITY
59-UNIT APARTMENT BUILDING
West Lisburn Road
RIDER MUSSER DEVELOPMENT, LLC
Upper Allen Township, Cumberland County

DRAWN/CHECKED	KS/JAB
JOB NUMBER	1133
DATE	01 MAR 18

OVERALL GROUND FLOOR PLAN
59 UNIT BUILDING

SHEET: **A1**